

**IMPORTANT – THIS COMMUNICATION AFFECTS YOUR PROPERTY**

**TOWN AND COUNTRY PLANNING ACT 1990**  
**(AS AMENDED BY THE PLANNING AND COMPENSATION**  
**ACT 1991)**

**ENFORCEMENT NOTICE**

To: The Owner/ Occupier  
land rear of Paragon House, Kiln Lane, Stallingborough, North East  
Lincolnshire

**ISSUED BY:** **NORTH EAST LINCOLNSHIRE COUNCIL ("the Council")**

1. THIS IS A FORMAL NOTICE which is issued by the Council because it appears to it that there has been a breach of planning control, under section 171A(1)(a) of the above act, at the land described below. It considers that it is expedient to issue this notice, having regard to the provisions of the development plan and to other material planning considerations. The annex at the end of the notice and the enclosures to which it refers contain important additional information.

2. **THE LAND AFFECTED**

The land rear of Paragon House, Kiln Lane, Stallingborough, North East Lincolnshire, shown edged in red on the attached plan. ("the land")

3. **THE MATTERS WHICH APPEAR TO CONSTITUTE THE BREACH OF PLANNING CONTROL**

Without planning permission, the installation of lighting columns and associated lighting units on the land.

4. **REASONS FOR ISSUING THIS NOTICE**

It appears that the breach of the above planning control has occurred within the last four years.

The unauthorised installation of the lighting columns and associated lighting units is contrary to the National Planning Policy Framework and Policies 5, 8, 9, 22, 41 and 42 of the North East Lincolnshire Local Plan 2013-2032 (adopted in 2018). This is because the development results in a significant loss of residential amenity for neighbouring properties due to the visual and light intrusion created by the lighting columns and lights.

The unauthorised works also have a significantly adverse impact on ecology and biodiversity due to the extent of the light spill/ pollution to the adjacent land which is a managed nature reserve in connection with the Humber Estuary Site of Special Scientific Interest.

The Council does not consider that planning permission should be given as planning conditions, screening or any other measures could not overcome these objections.

5. WHAT YOU ARE REQUIRED TO DO

Remove the unauthorised lighting columns and associated lighting units.

6. TIME FOR COMPLIANCE

3 months after this notice takes effect.

7. WHEN THIS NOTICE TAKES EFFECT

This notice takes effect on 11<sup>th</sup> July 2022 unless an appeal is made against it beforehand.

Dated: 9<sup>th</sup> June 2022

Signed:



On behalf of North East Lincolnshire Council

**Mark Nearney**

Assistant Director of Housing, Highways and Planning  
North East Lincolnshire Borough Council  
Municipal Offices  
Town Hall Square  
Grimsby  
North East Lincolnshire  
DN31 1HU

## **ANNEX**

### **YOUR RIGHT OF APPEAL**

You can appeal against this Notice, but any appeal must be received, or posted in time to be received, by the Secretary of State before the date specified in paragraph 7 of this notice. The Planning Inspectorate information sheet, which is included with this Notice, will give you the information needed to submit your Appeal. Please read it carefully.

**Please note, you MUST make sure that the Planning Inspectorate receives your appeal before the effective date on the Enforcement Notice.**

### **WHAT HAPPENS IF YOU DO NOT APPEAL**

If you do not appeal against this enforcement notice, it will take effect on the date specified in paragraph 7 of this notice and you must then ensure that the required steps for complying with it, for which you may be held responsible, are taken within the period(s) specified in the notice. Failure to comply with an enforcement notice which has taken effect can result in prosecution and/or remedial action by the Council.



North

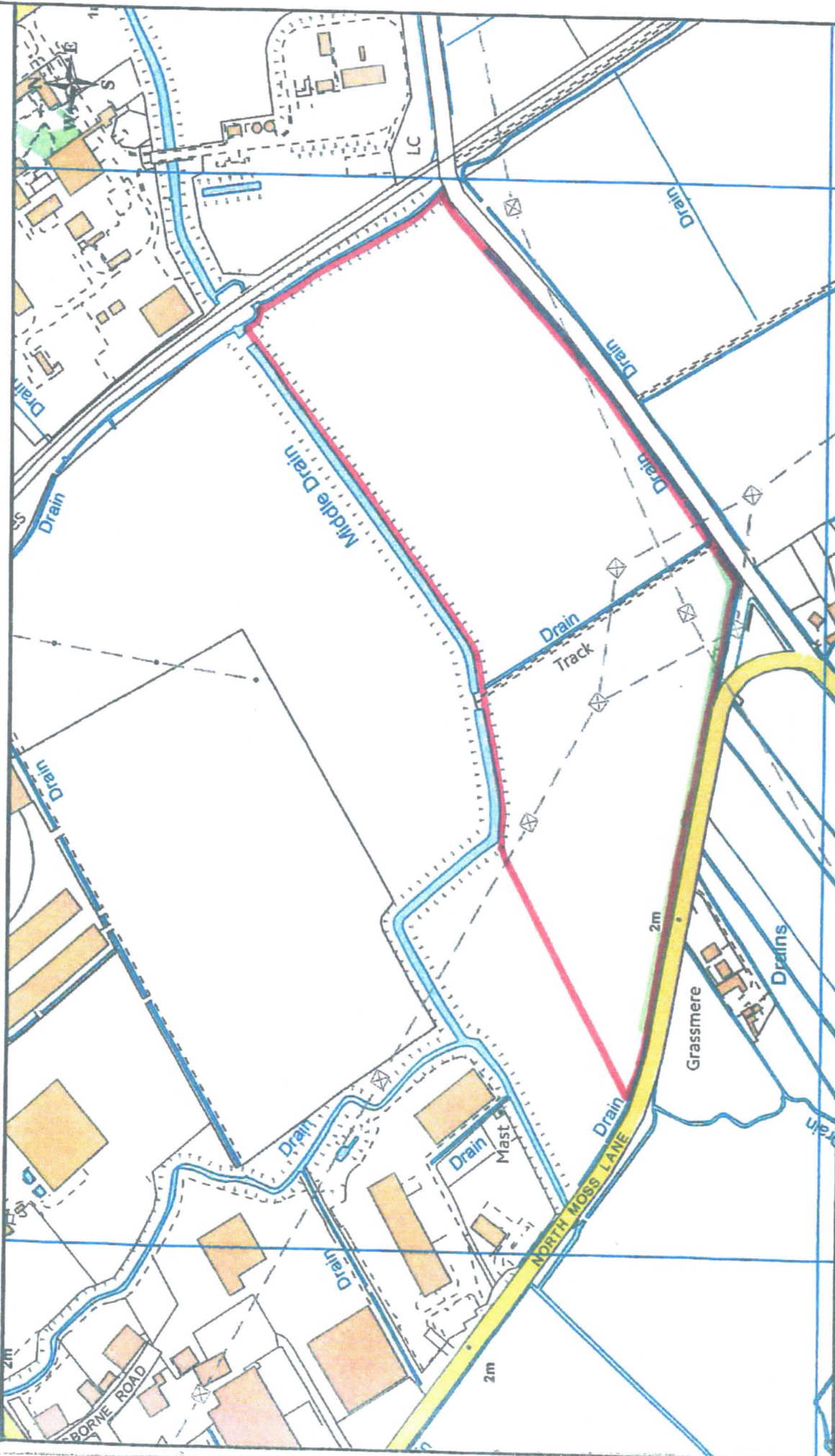

This product includes mapping data licensed from Ordnance Survey with the permission of the Controller of HMSO.  
© Crown copyright 2019.  
All rights reserved. Licence number 100020759

www.nelincs.gov.uk  
Civic Offices  
Kroil Street  
Clusborpes, DN38 8LN



Details  
Plotting in MapInfo made easier

Drawn By	Scale	Date
True	1:5000	18/12/2019
File / Pathname / Project / Drawing No.		

Rev

No.

www.nelincs.gov.uk