

Item 2

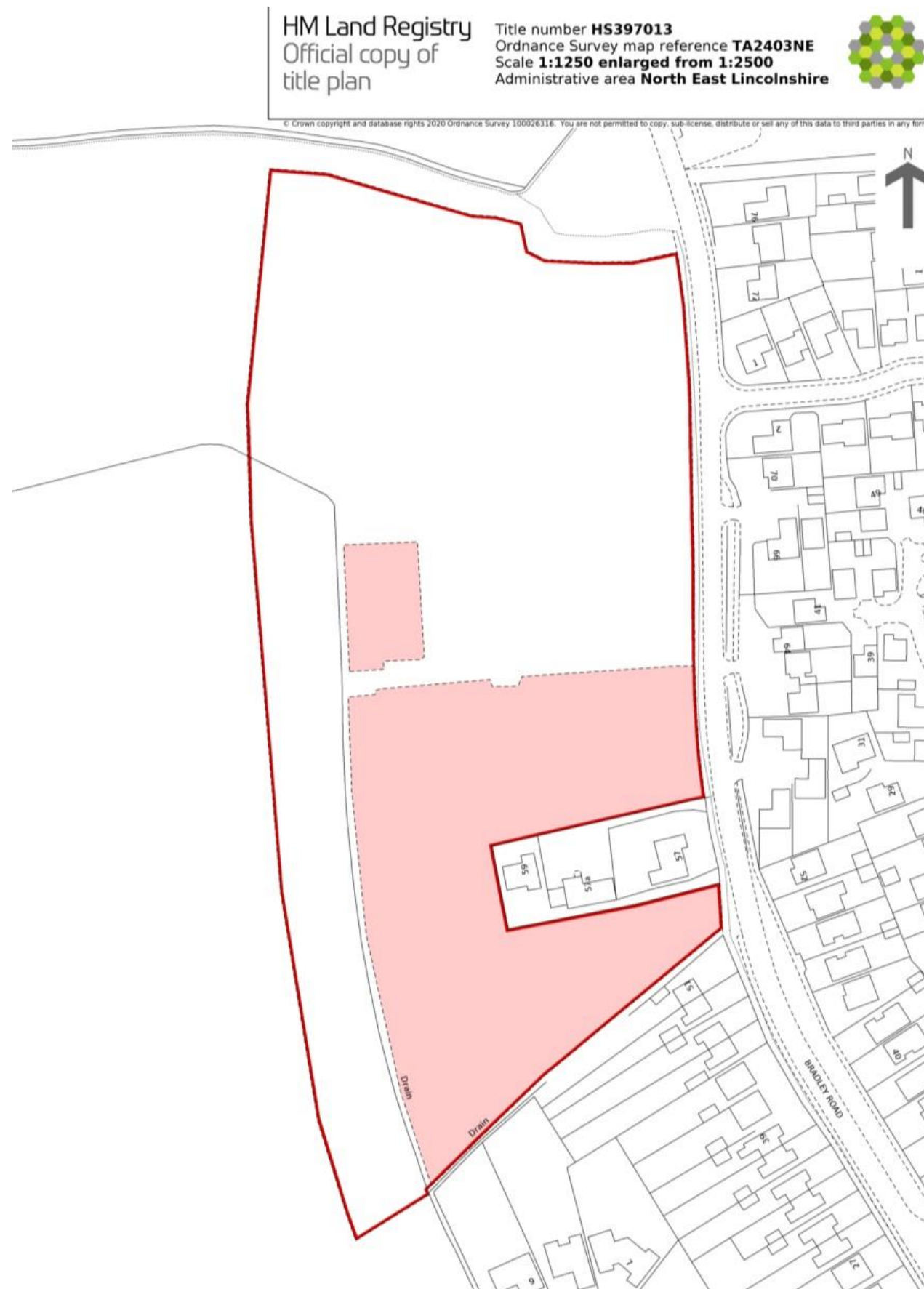



FIG. 4 - Plot 1 – 53 Bradley Road – Site Plan as per OS mapping data.









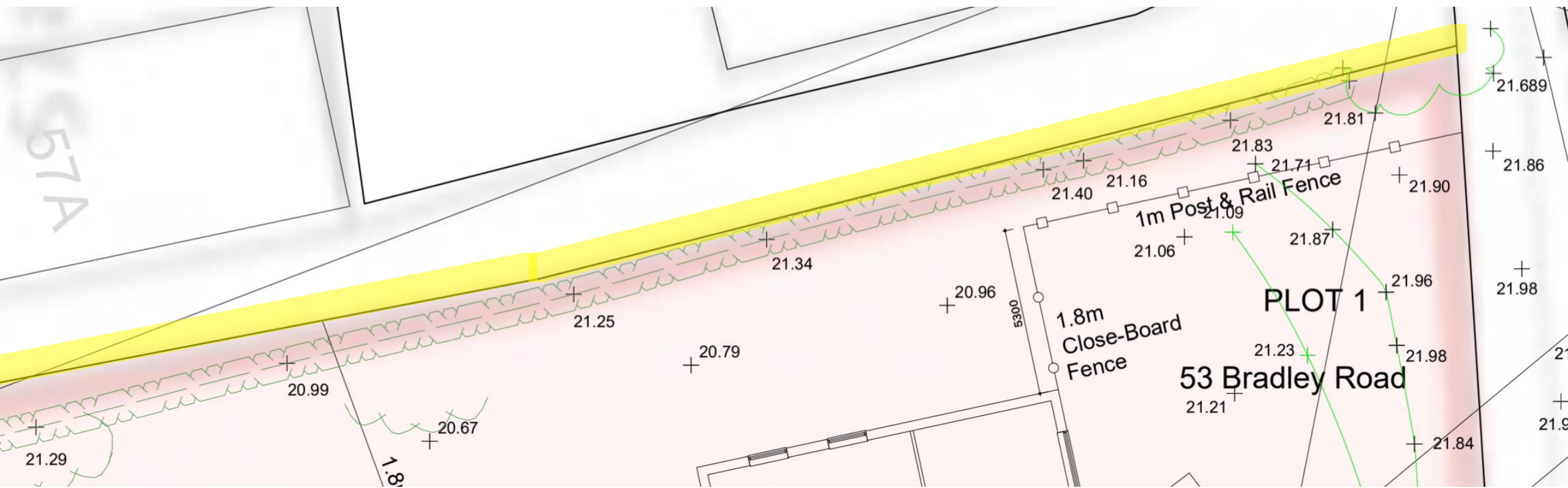

FIG. 7 - Enlarged View - showing the existing hedge (2016 survey) and the Title Deed red-line boundary. The yellow highlighted OS plan line dictates the boundary, note that the surveyed hedge sits within the limits of Plot 1's boundary. Also, note that the hedge has grown/spread considerably since the survey was undertaken.

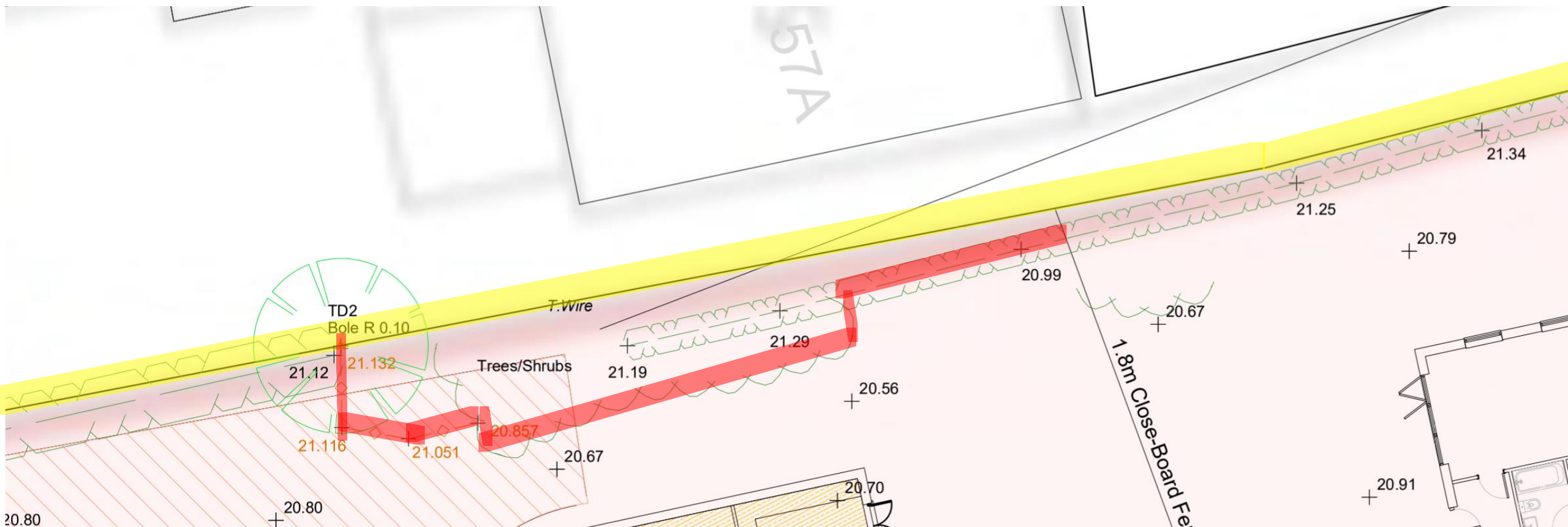

FIG. 8 - Enlarged View - showing encroachment onto Snape Homes site by neighbours at 57A and 59.