

This drawing and the design shown upon it is the intellectual property of Keir Architecture Ltd, and must not be copied or reproduced either in whole or in part without prior written permission of Keir Architecture Ltd Tel: 07813 006079.

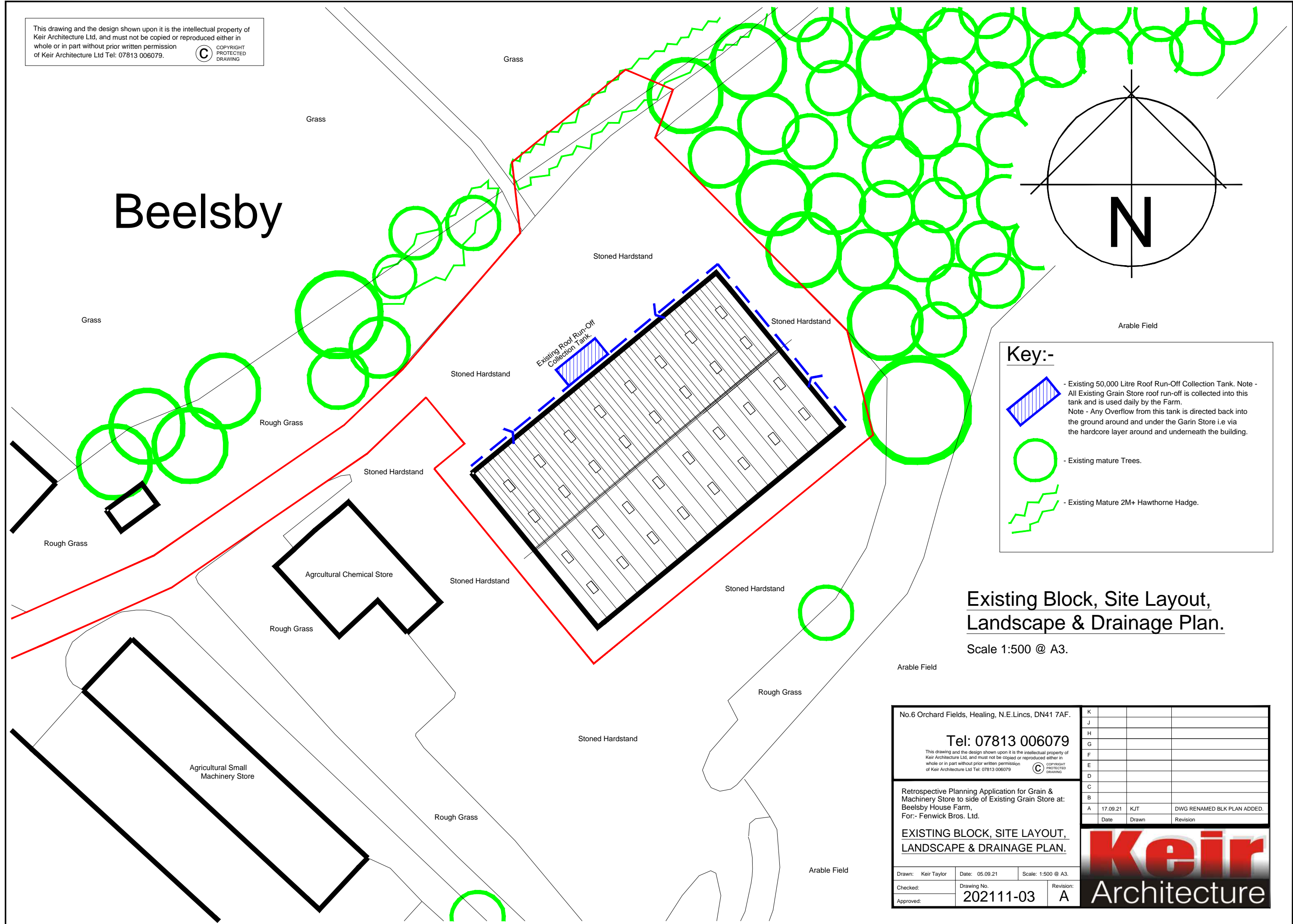

Beelsby



Key:-

- Existing 50,000 Litre Roof Run-Off Collection Tank. Note - All Existing Grain Store roof run-off is collected into this tank and is used daily by the Farm. Note - Any Overflow from this tank is directed back into the ground around and under the Grain Store i.e via the hardcore layer around and underneath the building.
- Existing mature Trees.
- Existing Mature 2M+ Hawthorne Hedge.

Existing Block, Site Layout, Landscape & Drainage Plan.
Scale 1:500 @ A3.

No.6 Orchard Fields, Healing, N.E.Lincs, DN41 7AF.
Tel: 07813 006079

This drawing and the design shown upon it is the intellectual property of Keir Architecture Ltd, and must not be copied or reproduced either in whole or in part without prior written permission of Keir Architecture Ltd Tel: 07813 006079.

Retrospective Planning Application for Grain & Machinery Store to side of Existing Grain Store at: Beelsby House Farm, For:- Fenwick Bros. Ltd.

EXISTING BLOCK, SITE LAYOUT, LANDSCAPE & DRAINAGE PLAN.

| | | |
|--------------------|-----------------------|--------------------|
| Drawn: Keir Taylor | Date: 05.09.21 | Scale: 1:500 @ A3. |
| Checked: | Drawing No. 202111-03 | Revision: A |
| Approved: | | |

| | | |
|---|----------|---------------------------------|
| K | | |
| J | | |
| H | | |
| G | | |
| F | | |
| E | | |
| D | | |
| C | | |
| B | | |
| A | 17.09.21 | KJT DWG RENAMED BLK PLAN ADDED. |
| | Date | Drawn Revision |

Keir Architecture