

Householder Pre-Application Form

Do I Need Planning Permission – Householder Developments

Please complete all sections relevant to your enquiry and return to either:

Planning@nelincs.gov.uk

or

North East Lincolnshire Planning, Municipal Offices, Town Hall Square, Grimsby,
North East Lincolnshire, DN31 1HU

The fee of £42 (inc VAT) can be made by credit or debit card by visiting North East Lincolnshire Council website <https://www.nelincs.gov.uk/planning-and-building-control/planning-applications/planning-permission/> or details, by cheque payable to North East Lincolnshire Council or by bank transfer (details on request).

We endeavour to respond to enquiries within 10 working days, however, it is possible that more information will be required before a response can be issued.

Please ensure that all measurements are provided in metres. Where possible, please provide site photographs and rough sketches.

Your information

Applicant Details

Name: _____

Address: _____

Postcode: _____

Telephone Number: _____

Email Address: _____

Agent Details (if applicable)

Name: _____

Company: _____

Address: _____

Postcode: _____

Telephone _____

Number: _____

Email Address: _____

Site Details

Site Address (If different from above): _____

Postcode: _____

Brief description of proposed works: _____

Is your property: _____

Is the site in a conservation area? Yes No

Is the building where the works are being carried out listed? Yes No

Extensions and Alterations (inc porches)

Where will the extension/alterations be (select all that apply): Front Side Rear

Will the proposal be within 2m of any boundary? Yes No

Are there any new windows proposed to the upper floor of any side wall or roof slope? Yes No

If yes, how many? _____

Please specify how high would this/they would be above the floor of the room in which it is to be installed: _____

And would it/they be obscurely glazed? Yes No Some but not all

Would any part of the proposal include a: veranda balcony raised platform none of these

Will the proposed materials match the existing house? Yes No

If No, what will they be: _____

External Walls: _____

Roof: _____

Doors and Windows: _____

Extensions & Porches Only

Will the extension be: Single Storey Two Storey Both

How far does the proposal project off the original wall?

Please provide height of the proposal in metres below: _____

Height to the eaves: _____

Height to the highest point: _____

Will the proposal, when combined with existing structures cover more than 50% of the curtilage/plot? (ie, the total area of the whole property excluding the ground area of the original dwelling house): Yes No

Will the proposal be higher than the highest part of the roof of the existing dwelling? Yes No

Will the eaves of the proposal be higher than the eaves of the existing dwelling? Yes No

Installation or Replacement Chimney, Flue or Soil and vent pipe

Would the proposal exceed the highest part of the existing dwelling roof by more than 1m? Yes No

If the site is within a conservation area, would the proposal be inserted onto a wall or roof slope which fronts a highway and forms either the principle (main) elevation or side elevation of the existing dwelling? Yes No

Alteration or Enlargement of a Dwelling Roof

Will the proposal be higher than the highest part of the existing roof? Yes No

Will the proposal extend beyond an existing roof slope which forms the principal elevation of the dwelling or fronts a highway? Yes No

What would the cubic volume of the extension/alteration be (height x width x depth)?

What would the proposed external materials be?

Would any part of the proposal include: a veranda a balcony raised platform none of these

Are there any new windows proposed to any side wall or rood slope? Yes No

If yes, please specify how high this would be above the floor of the room in which it is to be installed: _____

And would it be obscurely glazed? Yes No

If the proposal is for rooflights or solar panels, how far would it/they project beyond the plane of the roof slope? _____

Outbuildings within the Curtilage of the Dwelling

Please provide the external measurements of the proposal below: _____

Length: _____

Width: _____

Height to the eaves: _____

Height to the highest roof point: _____

Would any part of the proposal be within 2m of any boundary? Yes No

Would the building be: _____

Where would the buildings be positioned: To the front At the side At the rear

What is the intended use of the proposal? (I.e, domestic/business) _____

Would the proposal, when combined with existing structures (excluding the ground area of the original dwelling house), exceed 50% of the curtilage of the dwelling?

Yes No

Fences, Walls or Other Means of Enclosure

What would the total height be from ground level? _____

If this is a repair, would the proposal exceed its former height? Yes No

Would it be adjacent to a highway used by vehicular traffic or to the front of the property? Yes No

Hard Surfacing

What is the size of the area to be hard surfaced or replaced? _____

Please identify where in the curtilage (plot) this would be? (A plan showing this area would be useful) _____

What materials would be used? _____

How would surface water run-off be disposed of? _____

Where would surface water run off drain to? _____

Satellite Dishes

Do you have any existing satellite dishes? Yes No

If yes, how many? _____

How many are proposed? _____

Where would it/they be located? _____

What are the dimensions? _____

Length: _____

Height: _____

Width: _____

Does the property have a chimney? Yes No

When installed, would it be higher than the ridge of the existing dwelling?

Yes No

Domestic Solar Energy

Solar Panels

Where would the panels be on the dwelling? _____

Would it result in the highest part being higher than the highest part of the existing dwelling roof (excluding the chimney)? Yes No

How far would it/they project beyond the wall or plane of the roof slope? _____

If the solar panel is to be stand alone in the curtilage of the dwelling, how high would it/they be? _____

Would it/they be within 5m of any boundary? Yes No

How many would there be? _____

Would the surface area of the panels forming part of a stand-alone solar exceed nine square metres or any dimensions of its array exceed 3 square metres? Yes No

All Renewable Energy Proposals

Does the proposal include the installation, alteration or replacement of a: ground source water source air source heat pump none of these

Does the proposal include the installation, alteration or replacement of a flue, forming part of a biomass heating system? Yes No

If yes, would this exceed the highest part of the roof of the dwelling? Yes No

If yes, by how much? _____

Wind Turbines

Is the proposal to erect a wind turbine? Yes No

If yes, where would it be located? _____

How high would it be? _____

Would it be attached to the dwelling? Yes No

Sketches and Supporting Information

It is useful if you can provide an aerial plan roughly marking the location of your works. Photos of the area in which the works would be taking place should be included. You can also provide rough sketches in the space provided below.

Example Sketch

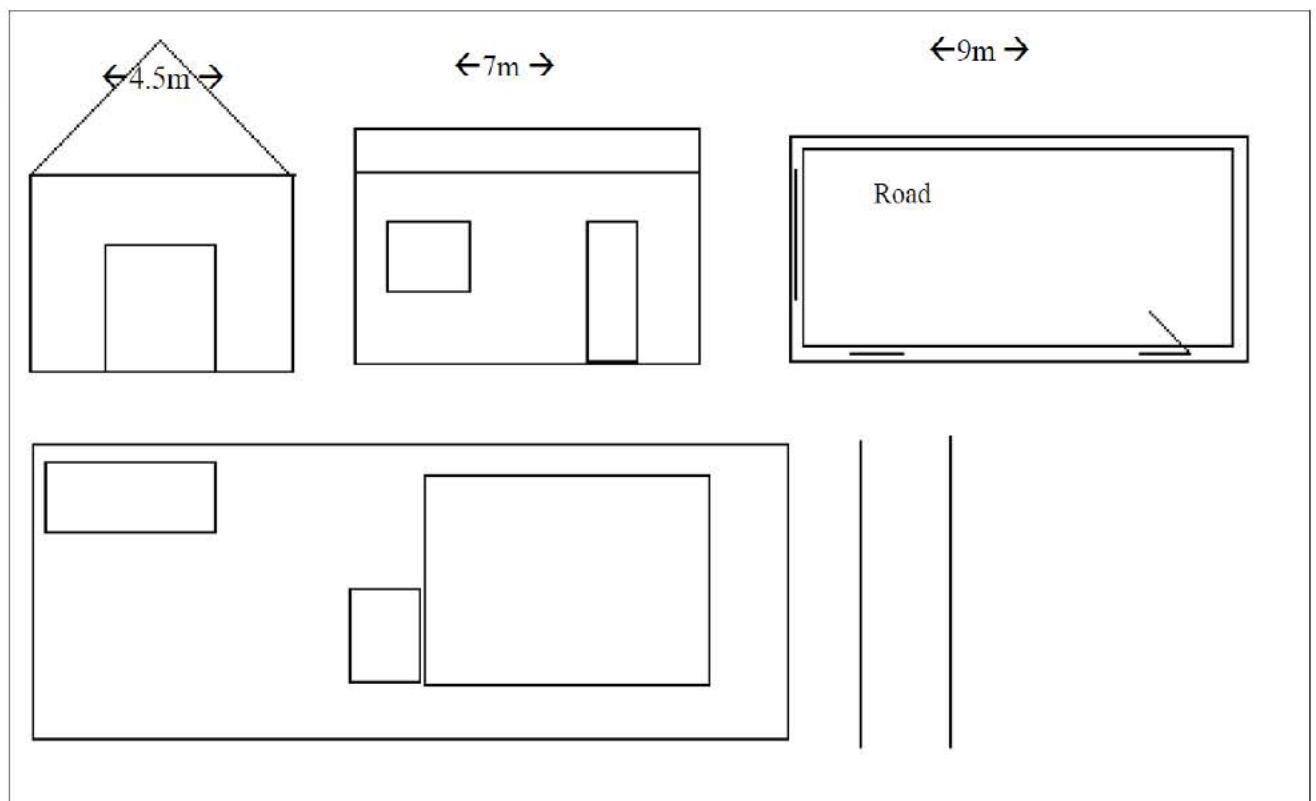



Other Information

You may also need Building Regulation Approval. Please call 01472 326289 Option 2 for more information on this.

The pre application service provides you with an informal opinion about your proposal. The formal way to determine if a proposal is authorised or not is to apply for a Certificate of Lawful Use. More information on this can be found on the [planning portal](#).